

GRADING NOTES:

1. ALL WORK SHOWN ON THIS PLAN SHALL BE DONE IN COMPLIANCE WITH ORDINANCE NO. 2676, CITY OF SAN BERNARDINO.
2. PERMIT TO ANY GRADING WORK BEING PERFORMED, A GRADING PERMIT SHALL BE OBTAINED FROM THE CITY ENGINEER'S OFFICE IN ACCORDANCE WITH SECTION 7009 (C) OF ORDINANCE NO. 2676.
3. MAXIMUM SLOPE: CUT 1% TO 1, FILL 2 TO 1.
4. TOP OF JOUES SHALL BE A MINIMUM OF 15' FROM PROPERTY LINE.
5. TOP OF STOPS SHALL BE A MINIMUM OF 3.0' FROM PROPERTY LINE.
6. ESTIMATE OF QUANTITIES: EXCAVATION, CONC, CURBS, EMBANKMENT, STOPS, CURBS, C/WARDS.
7. ALL WORK ON PLAN IS DESIGNATED AS "PROPOSED" GRADING AND EXCAVATION SHALL BE DONE UNDER THE SUPERVISION AND CONTROL OF THE SUPERVISING CIVIL ENGINEER.
8. SUPERVISING CIVIL ENGINEER: DONALD E. WALKER, C.E. 5409.
9. SOIL TESTING LABORATORY: DONALD E. WALKER CO.
10. ESTIMATED STARTING DATE: FEB. 1, 1968.
11. ESTIMATED COMPLETION DATE: DEC. 1, 1968.
12. BENCH MARK: JOURN IN SOUTH WEST CORNER RETURN OF SOUTH AVE. AND MULT ST. C/S 6.5' FROM RED CORNER OF SAN BERNARDINO ELEV. 1114.0.
13. ALL ABANDONED UTILITY LINES SHALL BE REMOVED OR COVERED 50' AS TO COMPLY WITH SECTION 7011, SUBSECTION (D) OF ORDINANCE NO. 2676 PRIOR TO BEING PLACED IN FILL.


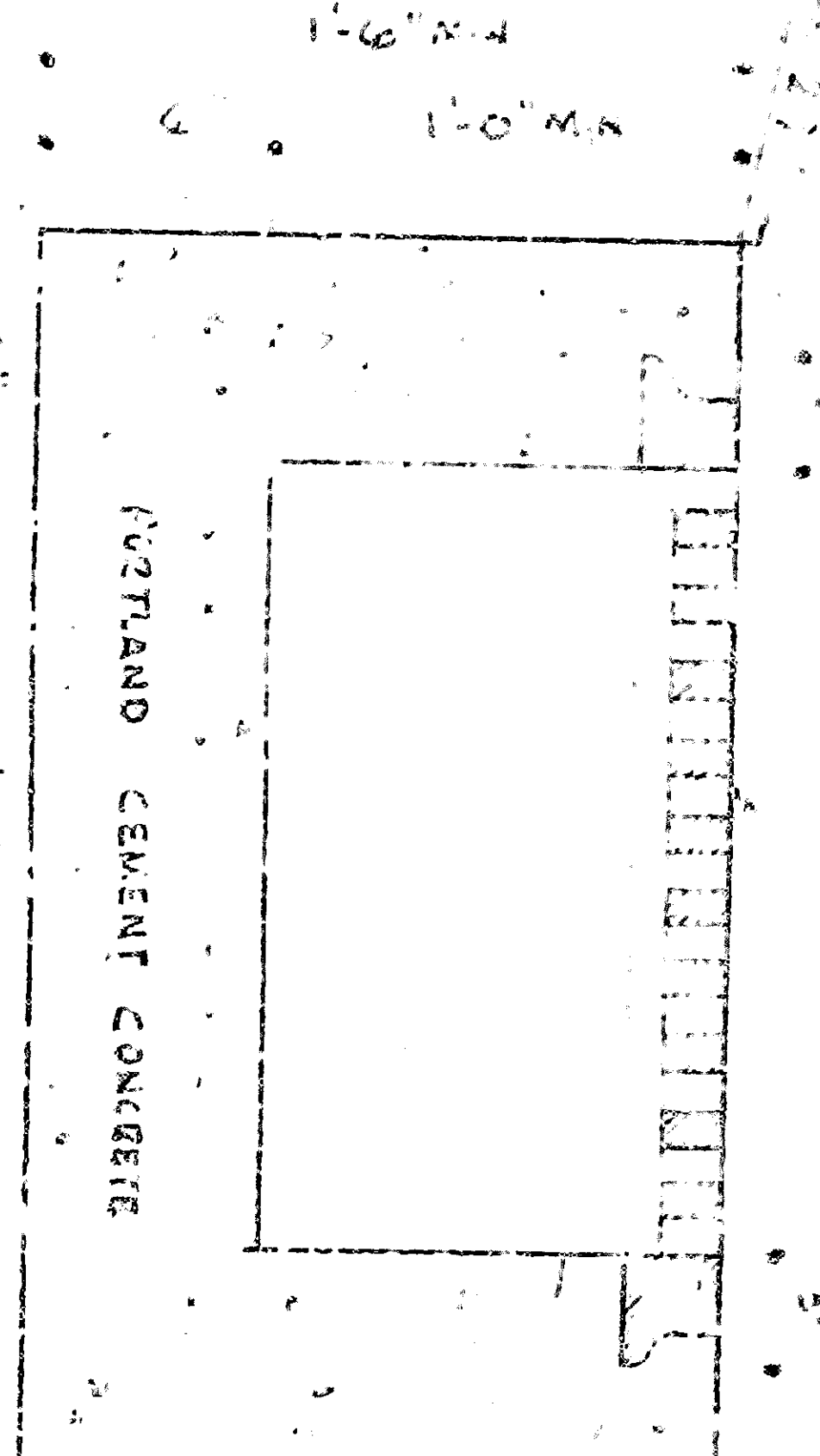

GRADING AND DRAINAGE

SCALE: 1"=30.00'

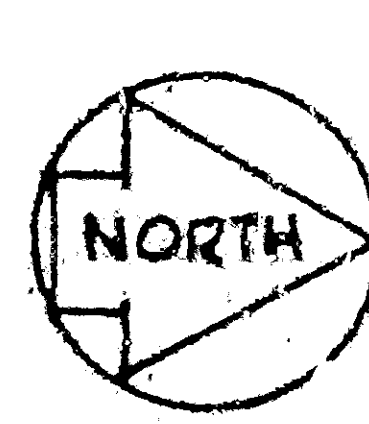

GRADING AND DRAINAGE - SOUTH PORTION

APPROVED: 2/15/1968
 DRAWING: 377A
 SHEET: 1

SUBMITTING CIVIL ENGINEER: *Donald E. Walker*
 CE 5409

CITY ENGINEER: RCE
 DEPT. OF ENGINEERING
 CITY OF SAN BERNARDINO, CALIF.